

Uszczelki włączów serii ST-Z

<p>Mod. G/170</p>	Art. nr	Material	Kolor	Temp.	Do włączów :
	96210	NBR	Biały/Whita RAL9016	-30°/ 110°C	Mod. 170
	96211	EPDM	Siwy/Grey RAL7040	-15°/ 90°C	Mod. 174/AE
	96215	SILIKON	Transparentny/Biały	-50°/200°C	Mod. 180
	96216	FPM/VITON	Czarny RAL 9017	-10°/ 250°C	Mod. 14/L
<p>Mod. G/15</p>	Art. nr	Material	Kolor	Temp.	Do włączów :
	96000	NBR	Biały/Whita RAL9016	-30°/ 110°C	Mod. 200
	96001	EPDM	Siwy/Grey RAL7040	-15°/ 90°C	Mod. 190 wersja do 29-02-2017
	96005	SILIKON	Transparentny/Biały	-50°/200°C	
	96006	FPM/VITON	Czarny RAL 9017	-10°/ 250°C	
<p>Mod. G/480</p>	Art. nr	Material	Kolor	Temp.	Do włączów :
	96460	NBR	Biały/Whita RAL9016	-30°/ 110°C	Mod. 191
	96461	EPDM	Siwy/Grey RAL7040	-15°/ 90°C	Mod. 190 wersja od 01-03-2017
	96465	SILIKON	Transparentny/Biały	-50°/200°C	
	96466	FPM/VITON	Czarny RAL 9017	-10°/ 250°C	
<p>Mod. G/200LZD</p>	Art. nr	Material	Kolor	Temp.	Do włączów :
	96040	NBR	Biały/Whita RAL9016	-30°/ 110°C	Mod. 200LZD
	96041	EPDM	Siwy/Grey RAL7040	-15°/ 90°C	Mod. 200LZD/C
	96045	SILIKON	Transparentny/Biały	-50°/200°C	
	96046	FPM/VITON	Czarny RAL 9017	-10°/ 250°C	
<p>Mod. G/200PES</p>	Art. nr	Material	Kolor	Temp.	Do włączów :
	96450	NBR	Biały/Whita RAL9016	-30°/ 110°C	Mod. 200PES
	96451	EPDM	Siwy/Grey RAL7040	-15°/ 90°C	Mod. 200PES snodo
	96455	SILIKON	Transparentny/Biały	-50°/200°C	
	96456	FPM/VITON	Czarny RAL 9017	-10°/ 250°C	
<p>Mod. G/630</p>	Art. nr	Material	Kolor	Temp.	Do włączów :
	96490	NBR	Biały/Whita RAL9016	-30°/ 110°C	Mod. 630
	96491	EPDM	Siwy/Grey RAL7040	-15°/ 90°C	
	96495	SILIKON	Transparentny/Biały	-50°/200°C	
	96496	FPM/VITON	Czarny RAL 9017	-10°/ 250°C	
<p>Mod.</p>	Art. nr	Material	Kolor	Temp.	Do włączów :
	96050	NBR	Biały/Whita RAL9016	-30°/ 110°C	Mod. 200R
	96051	EPDM	Siwy/Grey RAL7040	-15°/ 90°C	
	96055	SILIKON	Transparentny/Biały	-50°/200°C	
	96056	FPM/VITON	Czarny RAL 9017	-10°/ 250°C	
<p>Mod. G/200RP</p>	Art. nr	Material	Kolor	Temp.	Do włączów :
	96230	NBR	Biały/Whita RAL9016	-30°/ 110°C	Mod. 200RP
	96231	EPDM	Siwy/Grey RAL7040	-15°/ 90°C	
	96235	SILIKON	Transparentny/Biały	-50°/200°C	
	96236	FPM/VITON	Czarny RAL 9017	-10°/ 250°C	
<p>Mod. G/Z175</p>	Art. nr	Material	Kolor	Temp.	Do włączów :
	96180	NBR	Biały/Whita RAL9016	-30°/ 110°C	Mod. Z175
	96181	EPDM	Siwy/Grey RAL7040	-15°/ 90°C	
	96185	SILIKON	Transparentny/Biały	-50°/200°C	
	96186	FPM/VITON	Czarny RAL 9017	-10°/ 250°C	

Uszczelki włazów serii ST-Z

Mod. G/1500

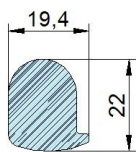

Art. nr	Material	Kolor	Temp.	Do włazów :
96420	NBR	Biały/Whita RAL9016	-30°/ 110°C	Mod. 1500 / 1400
96421	EPDM	Siwy/Grey RAL7040	-15°/ 90°C	Mod. 1500/AL
96425	SILIKON	Transparentny/Biały	-50°/200°C	Mod. 1600
96426	FPM/VITON	Czarny RAL 9017	-10°/ 250°C	Mod. 1700

Mod. G/295

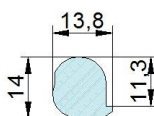

Art. nr	Material	Kolor	Temp.	Do włazów :
96020	NBR	Biały/Whita RAL9016	-30°/ 110°C	Mod. 285
96021	EPDM	Siwy/Grey RAL7040	-15°/ 90°C	Mod. 295
96025	SILIKON	Transparentny/Biały	-50°/200°C	
96026	FPM/VITON	Czarny RAL 9017	-10°/ 250°C	

Mod. G/R165

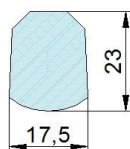

Art. nr	Material	Kolor	Temp.	Do włazów :
96200	NBR	Biały/Whita RAL9016	-30°/ 110°C	Mod. 160
96201	EPDM	Siwy/Grey RAL7040	-15°/ 90°C	Mod. 165
96205	SILIKON	Transparentny/Biały	-50°/200°C	Mod. 160/2B
96206	FPM/VITON	Czarny RAL 9017	-10°/ 250°C	

Mod. G/P200

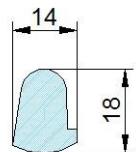

Art. nr	Material	Kolor	Temp.	Do włazów :
96100	NBR	Biały/Whita RAL9016	-30°/ 110°C	Mod. 230
96101	EPDM	Siwy/Grey RAL7040	-15°/ 90°C	Mod. 235
96105	SILIKON	Transparentny/Biały	-50°/200°C	Mod. 60
96106	FPM/VITON	Czarny RAL 9017	-10°/ 250°C	

Mod. G/AE

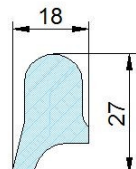

Art. nr	Material	Kolor	Temp.	Do włazów :
96410	NBR	Biały/Whita RAL9016	-30°/ 110°C	Mod. 220
96411	EPDM	Siwy/Grey RAL7040	-15°/ 90°C	Mod. 50
96415	SILIKON	Transparentny/Biały	-50°/200°C	Mod. N/100
96416	FPM/VITON	Czarny RAL 9017	-10°/ 250°C	Mod.250
				Mod. 90
				Mod. N/250
				Mod. 255
				Mod. 100
				Mod. C/330
				Mod. 110
				Mod. 220/E

Mod. G/TR300

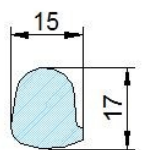

Art. nr	Material	Kolor	Temp.	Do włazów :
96470	NBR	Biały/Whita RAL9016	-30°/ 110°C	Mod. 210
96471	EPDM	Siwy/Grey RAL7040	-15°/ 90°C	Mod. 70
96475	SILIKON	Transparentny/Biały	-50°/200°C	Mod. 215
96476	FPM/VITON	Czarny RAL 9017	-10°/ 250°C	Mod. 80
				Mod. 240
				Mod. 245

Mod. G/TR500

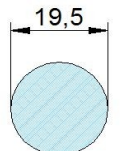

Art. nr	Material	Kolor	Temp.	Do włazów :
96170	NBR	Biały/Whita RAL9016	-30°/ 110°C	Mod. 520
96171	EPDM	Siwy/Grey RAL7040	-15°/ 90°C	Mod. 150
96175	SILIKON	Transparentny/Biały	-50°/200°C	Mod. 270
96176	FPM/VITON	Czarny RAL 9017	-10°/ 250°C	Mod. N/150
				Mod. N270
				Mod. 275

Mod. G/6V250

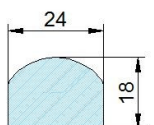

Art. nr	Material	Kolor	Temp.	Do włazów :
960	NBR	Biały/Whita RAL9016	-30°/ 110°C	Mod. 6V/250
961	EPDM	Siwy/Grey RAL7040	-15°/ 90°C	
965	SILIKON	Transparentny/Biały	-50°/200°C	
966	FPM/VITON	Czarny RAL 9017	-10°/ 250°C	

Mod. G/NL250

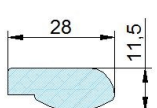

Art. nr	Material	Kolor	Temp.	Do włazów :
96220	NBR	Biały/Whita RAL9016	-30°/ 110°C	Mod. N/240/4V
96221	EPDM	Siwy/Grey RAL7040	-15°/ 90°C	Mod. N/240
96225	SILIKON	Transparentny/Biały	-50°/200°C	Mod. NL/250
96226	FPM/VITON	Czarny RAL 9017	-10°/ 250°C	

Uszczelki włazów serii ST-Z

Mod. G/400AZ/NL

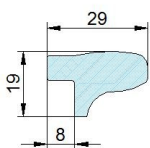

Art. nr	Material	Kolor	Temp.
96430	NBR	Biały/Whita RAL9016	-30°/ 110°C
96431	EPDM	Siwy/Grey RAL7040	-15°/ 90°C
96435	SILIKON	Transparentny/Biały	-50°/200°C
96436	FPM/VITON	Czarny RAL 9017	-10°/ 250°C

Do włazów :
Mod. 400/AZ-NL

Mod. G/T

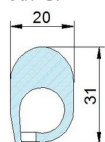

Art. nr	Material	Kolor	Temp.
96330	NBR	Biały/Whita RAL9016	-30°/ 110°C
96331	EPDM	Siwy/Grey RAL7040	-15°/ 90°C
96335	SILIKON	Transparentny/Biały	-50°/200°C
96336	FPM/VITON	Czarny RAL 9017	-10°/ 250°C

Do włazów :
Mod. 400/AZ-GN

Mod. G/T200

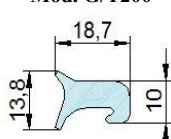

Art. nr	Material	Kolor	Temp.
96360	NBR	Biały/Whita RAL9016	-30°/ 110°C
96361	EPDM	Siwy/Grey RAL7040	-15°/ 90°C
96365	SILIKON	Transparentny/Biały	-50°/200°C
96366	FPM/VITON	Czarny RAL 9017	-10°/ 250°C

Do włazów :
Mod. N/230
Mod. T1/200
Mod. 3V/200

Mod. G/T300

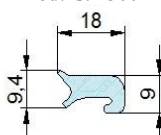

Art. nr	Material	Kolor	Temp.
96300	NBR	Biały/Whita RAL9016	-30°/ 110°C
96301	EPDM	Siwy/Grey RAL7040	-15°/ 90°C
96305	SILIKON	Transparentny/Biały	-50°/200°C
96306	FPM/VITON	Czarny RAL 9017	-10°/ 250°C

Do włazów :
Mod. T1/300
Mod. 3V/300

Mod. G/T400

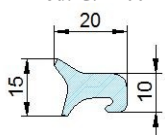

Art. nr	Material	Kolor	Temp.
96370	NBR	Biały/Whita RAL9016	-30°/ 110°C
96371	EPDM	Siwy/Grey RAL7040	-15°/ 90°C
96375	SILIKON	Transparentny/Biały	-50°/200°C
96376	FPM/VITON	Czarny RAL 9017	-10°/ 250°C

Do włazów :
Mod. T1/400
Mod. 3V/400
Mod. TV/400
Mod. T1/G400

Mod. G/T450

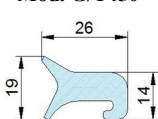

Art. nr	Material	Kolor	Temp.
96380	NBR	Biały/Whita RAL9016	-30°/ 110°C
96381	EPDM	Siwy/Grey RAL7040	-15°/ 90°C
96385	SILIKON	Transparentny/Biały	-50°/200°C
96386	FPM/VITON	Czarny RAL 9017	-10°/ 250°C

Do włazów :
Mod. T1/450, T1/G450
Mod. 5V/450
Mod. TV/450
Mod. T/450

Mod. G/T500

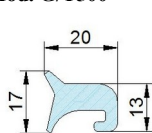

Art. nr	Material	Kolor	Temp.
96310	NBR	Biały/Whita RAL9016	-30°/ 110°C
96311	EPDM	Siwy/Grey RAL7040	-15°/ 90°C
96315	SILIKON	Transparentny/Biały	-50°/200°C
96316	FPM/VITON	Czarny RAL 9017	-10°/ 250°C

Do włazów :
Mod. T1/500, T1/G500
Mod. 6V/500
Mod. TV/500
Mod. T/500

Mod. G/T600

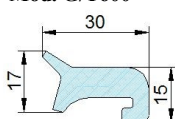

Art. nr	Material	Kolor	Temp.
96320	NBR	Biały/Whita RAL9016	-30°/ 110°C
96321	EPDM	Siwy/Grey RAL7040	-15°/ 90°C
96325	SILIKON	Transparentny/Biały	-50°/200°C
96326	FPM/VITON	Czarny RAL 9017	-10°/ 250°C

Do włazów :
Mod. T1/600
Mod. 8V/600
Mod. TV/600
Mod. T/600

Mod. G/T800

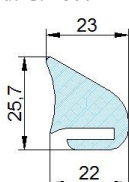

Art. nr	Material	Kolor	Temp.
96350	NBR	Biały/Whita RAL9016	-30°/ 110°C
96351	EPDM	Siwy/Grey RAL7040	-15°/ 90°C
96355	SILIKON	Transparentny/Biały	-50°/200°C
96356	FPM/VITON	Czarny RAL 9017	-10°/ 250°C

Do włazów :
Mod. T1/800
Mod. 10V/800

Uszczelki włazów serii ST-Z

Mod. G/300/P

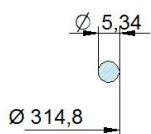

Art. nr	Material	Kolor	Temp.	Do włazów :
96600	NBR	Biały/Whita RAL9016	-30°/ 110°C	Mod. 300L
96601	EPDM	Siwy/Grey RAL7040	-15°/ 90°C	Mod. 300P
96605	SILIKON	Transparentny/Biały	-50°/200°C	
96606	FPM/VITON	Czarny RAL 9017	-10°/ 250°C	

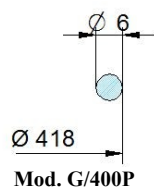

Art. nr	Material	Kolor	Temp.	Do włazów :
96250	NBR	Biały/Whita RAL9016	-30°/ 110°C	Mod. 400L
96251	EPDM	Siwy/Grey RAL7040	-15°/ 90°C	Mod. 400P
96255	SILIKON	Transparentny/Biały	-50°/200°C	
96256	FPM/VITON	Czarny RAL 9017	-10°/ 250°C	

Mod. G/450P

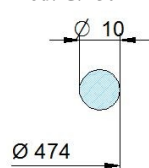

Art. nr	Material	Kolor	Temp.	Do włazów :
96260	NBR	Biały/Whita RAL9016	-30°/ 110°C	Mod. 450L
96261	EPDM	Siwy/Grey RAL7040	-15°/ 90°C	Mod. 450P
96265	SILIKON	Transparentny/Biały	-50°/200°C	
96266	FPM/VITON	Czarny RAL 9017	-10°/ 250°C	

Mod. G/500P

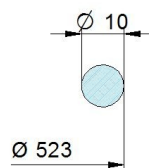

Art. nr	Material	Kolor	Temp.	Do włazów :
96270	NBR	Biały/Whita RAL9016	-30°/ 110°C	Mod. 500L
96271	EPDM	Siwy/Grey RAL7040	-15°/ 90°C	Mod. 500P
96275	SILIKON	Transparentny/Biały	-50°/200°C	
96276	FPM/VITON	Czarny RAL 9017	-10°/ 250°C	

Mod. G/600P

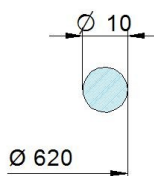

Art. nr	Material	Kolor	Temp.	Do włazów :
96280	NBR	Biały/Whita RAL9016	-30°/ 110°C	Mod. 600L
96281	EPDM	Siwy/Grey RAL7040	-15°/ 90°C	Mod. 600P
96285	SILIKON	Transparentny/Biały	-50°/200°C	
96286	FPM/VITON	Czarny RAL 9017	-10°/ 250°C	